



DILIPKUMAR & SONS

Mfg:
HDPE, PP, PPH, PVDF,
Pipe fittings And Ball Valves

Email: dkbindustrial2015@gmail.com

Profile

DILIPKUMAR & SONS one the leading manufacturers since the 2015 of he complete range of HDPE/PP/ Pipe Fittings. Our range includes fittings for all sizes ranging from 20 MM to 315 mm and all pressure classes ranging from PN-100-80 10 Kgs. & 6 Kgs.

Our customers are distributors, leading pipe manufacturers, project consultants and engineering companies, pharmaceuticals/chemical companies etc across India and abroad. **DILIPKUMAR & SONS** upholding its motto of pioneering, innovation, high quality and high efficiency, will keep its efforts in the promotion of its products to the whole world.

1. We believe in efficiency and teamwork will make us develop.
2. We believe in reliable quality and reasonable prices will make us competitive;
3. We believe in mutual benefits and customer satisfaction will make us stand in the lead of this trade.

We cordially welcome both our old friends and new customers to contact us for further cooperation.



DILIPKUMAR & SONS

Mfg:
HDPE, PP, PPH, PVDF,
Pipe fittings And Ball Valves

Email: dkbindustrial2015@gmail.com

QUALITY FOCUS

We realize the criticality of fittings in any pipe project. A single defect can have a huge impact on the whole project. Our fittings, manufactured only out of virgin pipe grade PE 80/ 100 material are subjected to a number of tests at our in-house testing facilities before they are sent to customers, so that you can rest assured of their performance. This focus has been justified by the long term relationships we have with our growing list of clients across India.

We're sure at some point you would have come across manufacturers of HDPE fittings offering there products surprisingly low rates. You will notice that the prices are close to what virgin material costs. This can only mean one thing... Use of reprocessed material!!!

Furthermore these fittings may not comply with relevant standards and the manufacturers may be penny pinching on overall dimensions of the fitting. It is our policy to supply fittings with wall thickness at the higher end of the standards set.

We urge you to sit back for a moment and consider the impact of using such fittings. You will find that the one time cost benefit achieved by using such fittings will be miniscule compared to the other expenses and risk to reputation you will incur because of the same.

After all you will agree it isn't sound business sense to risk a complete project for something that's going to be just 7-10% of the total project cost



DILIPKUMAR & SONS

Mfg:
HDPE, PP, PPH, PVDF,
Pipe fittings And Ball Valves

Email: dkbindustrial2015@gmail.com

ACHIVEMENT

**IN ALL OVER INDIA ONLY WE ARE MFG THE SINGLE PIECE 315 MM
ELBOW & TEE**

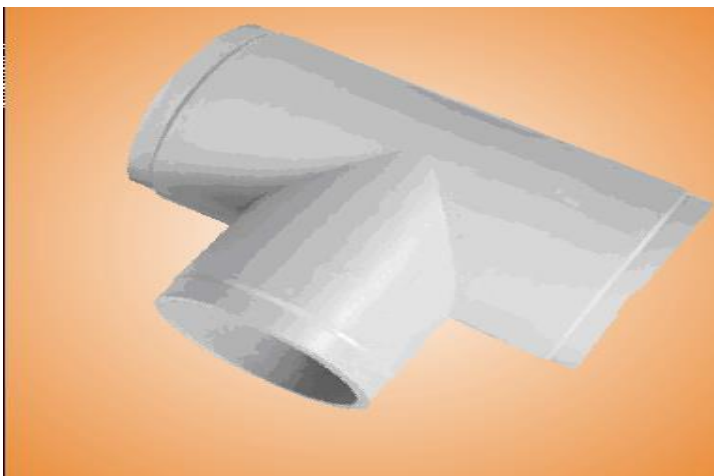



DILIPKUMAR & SONS

Mfg:
HDPE, PP, PPH, PVDF,
Pipe fittings And Ball Valves

Email: dkbindustrial2015@gmail.com

PRODUCTS CATALOGUE

1.MOULDED FITTING

ELBOW (BEND)



TEE (EQUAL)



LONGECK PIP END (L.N)



SHORT NECK PIPE END (S.N)



REDUCERS





DILIPKUMAR & SONS

Mfg:
HDPE, PP, PPH, PVDF,
Pipe fittings And Ball Valves

Email: dkbindustrial2015@gmail.com

PRODUCTS CATALOGUE

REDUCERS TEE

	<p>Size : 20mm OD to 315mm OD Weld Type : Butt Weld</p> <p>Pressure : 6 Kg/ cm₂ and 10 Kg/ cm₂ Material : HDPE / PP / PPH</p>
-----------------------------------------------------------------------------------	-------------------------------------------------------------------------------------------------------------------------------------------------------------

TAIL PIECE (NOZZLE)

	<p>Size : 20mm OD to 315mm OD Weld Type : Butt Weld</p> <p>Pressure : 6 Kg/ cm₂ and 10 Kg/ cm₂ Material : HDPE / PP / PPH</p>
------------------------------------------------------------------------------------	-------------------------------------------------------------------------------------------------------------------------------------------------------------

SLIPON FLANGE

	<p>Size : 20mm OD to 630mm OD Weld Type : Butt Weld</p> <p>Pressure : 6 Kg/ cm₂ and 10 Kg/ cm₂ Material : HDPE / PP / PPH</p>
-------------------------------------------------------------------------------------	-------------------------------------------------------------------------------------------------------------------------------------------------------------

BLIND FLANGE

	<p>Size : 20mm OD to 630mm OD Weld Type : Butt Weld</p> <p>Pressure : 6 Kg/ cm₂ and 10 Kg/ cm₂ Material : HDPE / PP / PPH</p>
-------------------------------------------------------------------------------------	-------------------------------------------------------------------------------------------------------------------------------------------------------------

END CAP

	<p>Size : 20mm OD to 400mm OD Weld Type : Butt Weld</p> <p>Pressure : 6 Kg/ cm₂ and 10 Kg/ cm₂ Material : HDPE / PP / PPH</p>
-------------------------------------------------------------------------------------	-------------------------------------------------------------------------------------------------------------------------------------------------------------



DILIPKUMAR & SONS

Mfg:
HDPE, PP, PPH, PVDF,
Pipe fittings And Ball Valves

Email: dkbindustrial2015@gmail.com

P.P PIPE FITTING

2. P.P PIPE FITTING

P.P HOSE NIPPLE FLANGE END

	<p>Size : 1" X 3/4" OD to 4" X 4" Weld Type : Butt Weld</p> <p>Pressure : 6 Kg/ cm₂ and 10 Kg/ cm₂ Material : P.P</p>
-----------------------------------------------------------------------------------	-----------------------------------------------------------------------------------------------------------------------------------------------------

PIPEBORE FLANGE

	<p>Size : 20mm OD to 630mm OD Weld Type : Butt Weld</p> <p>Pressure : 6 Kg/ cm₂ and 10 Kg/ cm₂ Material : P.P</p>
-----------------------------------------------------------------------------------	-------------------------------------------------------------------------------------------------------------------------------------------------

THREADED FLANGE

	<p>Size : 20mm OD to 630mm OD Weld Type : Butt Weld</p> <p>Pressure : 6 Kg/ cm₂ and 10 Kg/ cm₂ Material : P.P</p>
-------------------------------------------------------------------------------------	-------------------------------------------------------------------------------------------------------------------------------------------------

BLIND FLANGE

	<p>Size : 20mm OD to 630mm OD Weld Type : Butt Weld</p> <p>Pressure : 6 Kg/ cm₂ and 10 Kg/ cm₂ Material : HDPE / PP / PPH</p>
-------------------------------------------------------------------------------------	-------------------------------------------------------------------------------------------------------------------------------------------------------------

SOCKET WELD PLAIN BEND

	<p>Size : 20mm OD to 160mm OD Weld Type : Butt Weld</p> <p>Pressure : 6 Kg/ cm₂ and 10 Kg/ cm₂ Material : P.P</p>
-------------------------------------------------------------------------------------	-------------------------------------------------------------------------------------------------------------------------------------------------



DILIPKUMAR & SONS

Mfg:
HDPE, PP, PPH, PVDF,
Pipe fittings And Ball Valves

Email: dkbindustrial2015@gmail.com

P.P PIPE FITTING

2. P.P PIPE FITTING

SOCKET WELD THREADED BEND



Size : 20mm OD to 160mm OD
Weld Type : Butt Weld
Pressure : 6 Kg/ cm₂ and 10 Kg/ cm₂
Material : P.P

SOCKET WELD PLAIN TEE



Size : 20mm OD to 160mm OD
Weld Type : Butt Weld
Pressure : 6 Kg/ cm₂ and 10 Kg/ cm₂
Material : P.P

SOCKET WELD PLAIN TEE



Size : 20mm OD to 160mm OD
Weld Type : Butt Weld
Pressure : 6 Kg/ cm₂ and 10 Kg/ cm₂
Material : P.P

COUPLER PLAIN



Size : 20mm OD to 160mm OD
Weld Type : Butt Weld
Pressure : 6 Kg/ cm₂ and 10 Kg/ cm₂
Material : P.P

COUPLER THREADED



Size : 20mm OD to 160mm OD
Weld Type : Butt Weld
Pressure : 6 Kg/ cm₂ and 10 Kg/ cm₂
Material : P.P



DILIPKUMAR & SONS

Mfg:
HDPE, PP, PPH, PVDF,
Pipe fittings And Ball Valves

Email: dkbindustrial2015@gmail.com

3. FEBRICATED FITTINGS

FEBRICATED ELBOW 45°

	<p>Size : 20mm OD to 630mm OD Weld Type : Butt Weld</p> <p>Pressure : 6 Kg/ cm₂ and 10 Kg/ cm₂ Material : H.D.P.E</p>
-----------------------------------------------------------------------------------	-----------------------------------------------------------------------------------------------------------------------------------------------------

FEBRICATED TEE

	<p>Size : 20mm OD to 630mm OD Weld Type : Butt Weld</p> <p>Pressure : 6 Kg/ cm₂ and 10 Kg/ cm₂ Material : H.D.P.E</p>
-----------------------------------------------------------------------------------	-----------------------------------------------------------------------------------------------------------------------------------------------------

FEBRICATED ELBOW

	<p>Size : 20mm OD to 630mm OD Weld Type : Butt Weld</p> <p>Pressure : 6 Kg/ cm₂ and 10 Kg/ cm₂ Material : P.P</p>
-------------------------------------------------------------------------------------	-------------------------------------------------------------------------------------------------------------------------------------------------

4. HDPE TLPS FLANG

HDPE TLPS FLANG

	<p>Size : 20mm OD to 315mm OD Weld Type : Butt Weld</p> <p>Pressure : 6 Kg/ cm₂ and 10 Kg/ cm₂ Material : P.P</p>
-------------------------------------------------------------------------------------	-------------------------------------------------------------------------------------------------------------------------------------------------



DILIPKUMAR & SONS

Mfg:
HDPE, PP, PPH, PVDF,
Pipe fittings And Ball Valves

Email: dkbindustrial2015@gmail.com

5. P.P JOENT FLANGE

P.P JOENT FLANGE



Size : 75 mm OD to 160 mm OD
Weld Type :
Pressure : 6 Kg/ cm₂ and 10 Kg/ cm₂
Material : P.P

6. SERVICE SADDLE

SERVICE SADDLE



Size : 40 MM to 315 MM
Material : PP BACK
Application : Irrigation, Industries

7. SCOOP & SCRAPER

SCOOP



Use : Use in industrial
Application : Pharmaceuticals, Chemical
Industries

SCRAPER



Use : Use in industrial
Application : Pharmaceuticals, Chemical
Industries



WIN+WIN IND PRODUCT

Mfg:
HDPE, PP, PPH, PVDF,
Pipe fittings And Ball Valves

Email: win+winindproduct@gmail.com

BALL VALVES

8. BALL VALVES

BALL VALVE FALNGED

	<p>Size : 3/4" to 6" inch Pressure : 10 Kg/ cm² Material : HDPE / PP / PPH</p>
-----------------------------------------------------------------------------------	---------------------------------------------------------------------------------------------------

BALL VALVE THREADED (SCREWEND)

	<p>Size : 3/4" to 6" inch Pressure : 10 Kg/ cm² Material : HDPE / PP / PPH</p>
-----------------------------------------------------------------------------------	---------------------------------------------------------------------------------------------------

FLOW INDIACTOR VALVE

	<p>Use : Use in industrial Application : Pharmaceuticals, Chemical Industries</p>
-------------------------------------------------------------------------------------	---------------------------------------------------------------------------------------

FOOT VALVE FLANGED

	<p>Size : 3/4" to 4" Inch Pressure : 10 Kg/ cm² Material : PP / PPH</p>
-------------------------------------------------------------------------------------	--------------------------------------------------------------------------------------------

FOOT VALVE THREADED

	<p>Size : 3/4" to 4" Inch Pressure : 10 Kg/ cm² Material : PP / PPH</p>
-------------------------------------------------------------------------------------	--------------------------------------------------------------------------------------------



DILIPKUMAR & SONS

Mfg:
HDPE, PP, PPH, PVDF,
Pipe fittings And Ball Valves

Email: dkbindustrial2015@gmail.com

COMPRESSION FITTINGS

9. COMPRESSION FITTINGS

COUPLER



Size : 20mm to 110mm
Material : PP
Application : In Cable pipeline,
Irrigation

ELBOW



Size : 20mm to 110mm
Material : PP
Application : In Cable pipeline,
Irrigation

MALE THREADED ADOPTER (MTA)



Size : 20mm to 110mm
Material : PP
Application : In Cable pipeline,
Irrigation

TEE



Size : 20mm to 110mm
Material : PP
Application : In Cable pipeline,
Irrigation



DILIPKUMAR & SONS

Mfg:
HDPE, PP, PPH, PVDF,
Pipe fittings And Ball Valves

Email: dkbindustrial2015@gmail.com

DRAIN TRAP

10. DRAIN TRAP

DRAIN TRAP



Size : 20mm to 110mm
Material : PP
Application : In Cable pipeline,
Irrigation

Drain Trap Introduction

We introduce a new concept in industrial Floor Drain Traps. It is a perfect substitute of the conventional fabricated traps used in R & D centers, Pharmaceuticals [Bulk Drug / Formulation], Healthcare, Food and Chemical Biotech industries. It makes care of the problems faced in conventional fabricated traps where HDPE Drain Pipes are used.

We use virgin Prime Grade of HDPE. This grade complies with the requirement of Indian Standard IS - 10146 on Polyethylene for its use in contact with foodstuff, pharmaceuticals and drinking water.

Single piece molded parts guarantee uniform quality and consistency. Glossy finished internals are interchangeable and insure smooth flow. Detachable drain baskets facilitate easy sanitizing. Main body with 15 mm wall thickness & concrete grooves makes it sturdy and insures mechanical strength. It does not have any hidden crevices and pockets in which foreign particles and waste matter may lodge.

Well-designed HDPE Trap does not encourage build-up of vermin and offensive odors. Large enough entrance and outlet insure anticipated volume of wastewater.

HDPE end piece, which is to be weld joined with the HDPE drainpipe, insures leak proof joint preventing water seepage into the concrete

Total height for Standard design is 300 mm. However shorter heights can be offered on request.

Colors other than natural white can be offered for bulk requirements.



DILIPKUMAR & SONS

Mfg:
HDPE, PP, PPH, PVDF,
Pipe fittings And Ball Valves

Email: dkbindustrial2015@gmail.com

Address

Sarkhej Sanand cross Road,
Sarkhej, Ahmedabad-382210

Factory plot no 04 samved industrial estate vadsar road
Gandhinagar

Email:

dkbindustrial2015@gmail.com dkbengineering2015@gmail.com

Contact Person

Dhaval Mehta: (Mo)9624081113, 9429617300

Customer Care No: 9428219498

